

INSTALLATION INSTRUCTIONS AND PARTS LIST

APPLICATION:

MODEL 400937 WHEEL TO WHEEL STEP BRACKETS:
2009 DODGE RAM 1500 REGULAR/QUAD/CREW CAB PICKUPS



1. READ INSTRUCTIONS COMPLETELY AND CHECK TO MAKE SURE THAT ALL REQUIRED PARTS (LISTED ON THE SERVICE PARTS LIST) ARE ON HAND BEFORE STARTING THE INSTALLATION.
2. ATTACH THE MOUNTING BRACKETS TO THE VEHICLE AS FOLLOWS: [SEE FIG. 1]
 - 2.1 ON THE VERTICAL WALL OF THE ROCKER PANEL, INSTALL THE T-BOLT WELMENT (ITEM #2) INTO THE LARGE OBOUNDED HOLE AND FISH THE OTHER END THROUGH THE FORWARD 1/2" HEXAGON HOLE **BE CAREFUL NOT TO DROP THE T-BOLT INSIDE OF THE ROCKER PANEL.** ATTACH THE FLAT NYLON WASHER (ITEM #4) TO THE THREADED END OF EACH BOLT. (THIS IS TO BE USED AS A RETAINER.)
 - 2.2 POSITION THE MOUNTING BRACKET (ITEM #1) SO THAT THE HOLES IN THE BRACKETS LINE UP WITH THE THREADED STUDS ON THE INSIDE WALL OF THE ROCKER PANEL. INSTALL THE 3/8-16 SERRATED FLANGE NUTS (ITEM #3). TIGHTEN BRACKET FASTENERS TO 19 LB FT.
 - 2.3 ASSEMBLE THE DOUBLE ENDED STUD & FASTENERS TO THE BRACKETS AS FOLLOWS:
 - 2.4 INSTALL 3/8" SERRATED FLANGE NUTS (ITEM #3) BACKWARDS, TO THE END OF THE THREAD, ON EACH END OF THE DOUBLE ENDED STUD (ITEM #6).
 - 2.5 ON (1) THREADED END OF THE STUD, INSTALL A 3/8" FLAT WASHER (ITEM #7) AND THEN PUSH THE 3/4" THICK RUBBER WASHER (ITEM #5) AND FLAT WASHER TIGHT UP AGAINST THE SERRATED FLANGE NUT. **(THE END OF THE DOUBLE ENDED STUD SHOULD BE RECESSED BACK IN THE HOLE OF THE RUBBER WASHER APPROXIMATELY 3/16").**
 - 2.6 INSTALL THE SECOND THREADED END OF THE STUD ASSEMBLY THRU THE HOLE IN THE BRACKET (ITEM# 1) AS SHOWN AND INSTALL A 3/8" SERRATED FLANGE NUT. (FINGER TIGHT ONLY).
 - 2.7 POSITION SNUG AGAINST FRAME RAIL AND TIGHT ALL FASTENERS. THIS WILL REINFORCE THE STEP.
3. ATTACH THE MOUNTING BRACKETS TO THE BOX OF THE VEHICLE AS FOLLOWS:
 - 3.1. ATTACH THE INBOARD MOUNTING BRACKETS (ITEM #11 &12) TO THE FRAME AS SHOWN USING 1/2-13 X 1.00 HEX SCREW, 1/2" WASHER, AND 1/2-13 SERRATED FLANGE NUTS (ITEM #14,15,16). **NOTE THAT THESE MOUNTING BRACKETS ARE NOT THE SAME FROM LEFT TO RIGHT.**
 - 3.2. ATTACH THE REAR OUTBOARD MOUNTING BRACKET (ITEM #13) TO THE INBOARD BRACKET USING THE 5/16" X 1.00" HEX HD CAP SCREWS (ITEM #8), 5/16" FLAT WASHERS (ITEM #10) AND 5/16" SERRATED FLANGE NUTS (ITEM #9) AS SHOWN.
4. ATTACHING THE STEP ASSEMBLY:

PLEASE REVIEW THE INSTALLATION INSTRUCTIONS THAT ARE INCLUDED IN YOUR STEP ASSEMBLY FOR SPECIFIC DETAILS.



(A LIVERNE Company)

1200 E. Birch St.

Brandon, SD 57005

REVISION B 05MAR12
REVISION A 20JAN11
551884 SHEET 1 OF 3 28SEP10

INSTALLATION INSTRUCTIONS AND PARTS LIST

APPLICATION:

MODEL 400937 WHEEL TO WHEEL STEP BRACKETS:
2009 DODGE RAM 1500 REGULAR/QUAD/CREW CAB PICKUPS

SERVICE PARTS LIST

ITEM	PART NO.	QTY	DESCRIPTION
PARTS INCLUDED IN THE BRACKET PACKAGE			
1	551656	6	MOUNTING BRACKET, BLK, DODGE, GRIP STEP
2	550147	6	T-BOLT WELDMENT, ZP
3	100181	30	NUT-SERRATED FLANGE,HEX,3/8-16,ZP
4	108442	12	WASHER-NYLON,.360 X 1.50 X .032
5	102592	6	WASHER-RUBBER,.354 X 1.00 X .748
6	551899	6	STUD-DBL THREADED,3/8-16 X 11.00,ZP
7	100062	6	WASHER-FLT,3/8,ZP
8	106997	4	SCR- HHC, 5/16-18 X 1.00", SST, BZP
9	106996	4	NUT- SERR FLG, HEX, SST, 5/16-18UNC, BLK ZP
10	106998	4	WASHER- PL, SST, 5/16", .75 ID X .875 OD X .083 THK, BZP
11	551693	1	BRKT- MTG, STEP, REAR INBOARD, LH
12	551694	1	BRKT- MTG, STEP, REAR INBOARD,RH
13	551721	2	BRKT- MTG, STEP, REAR OUTBOARD,RH/LH
14	100085	2	SCREW-HEX, 1/2-13 X 1.00,ZP
15	100118	2	WASHER-FLAT, 1/2",ZP
16	100123	2	NUT-HEX,SERRATED FLANGE, 1/2-13,ZP



1200 E. Birch St.

Brandon, SD 57005

REVISION B 05MAR12
REVISION A 20JAN11
551884 SHEET 2 OF 3 28SEP10

SERVICE PARTS LIST

MODEL NO. -400937

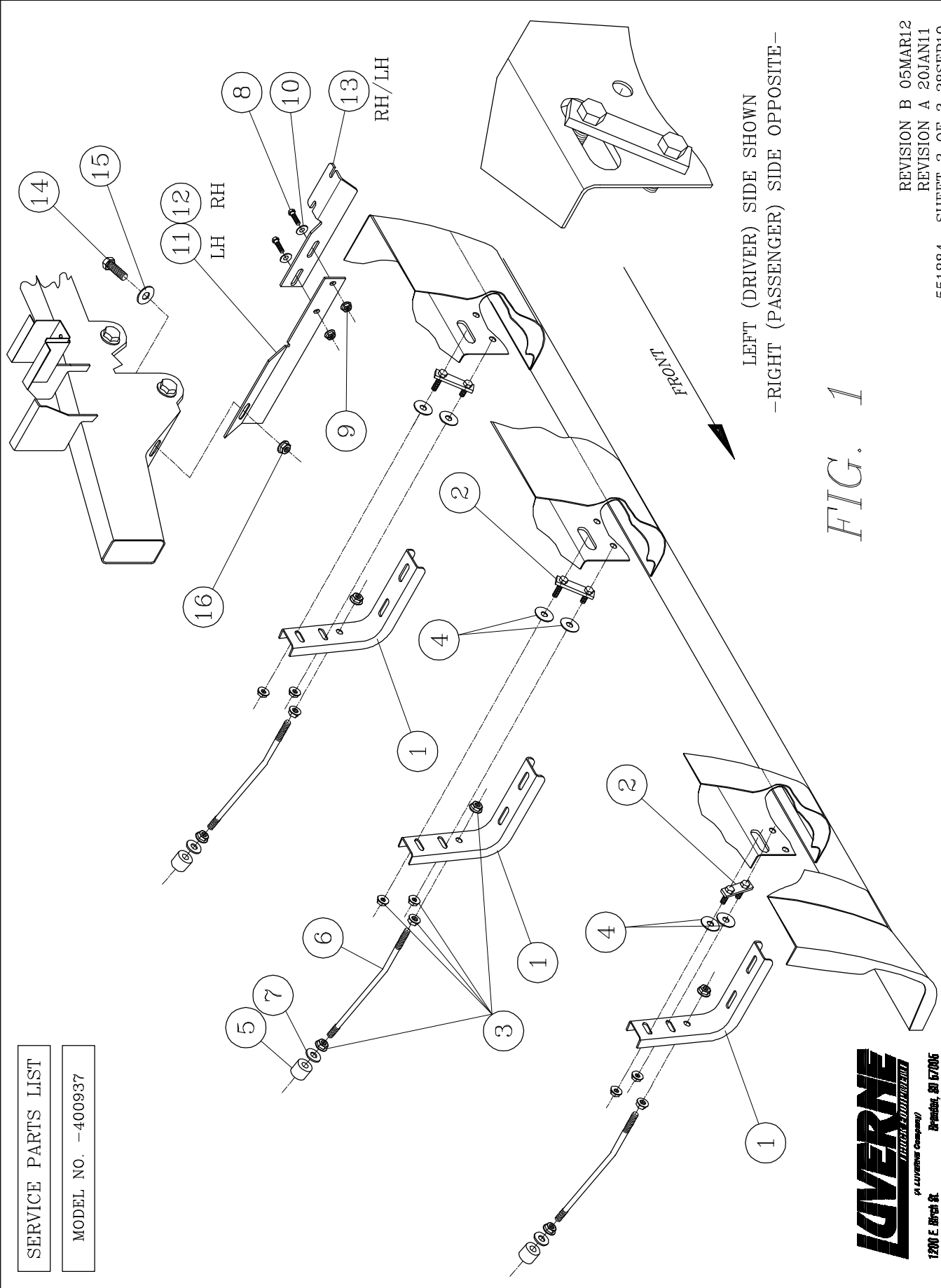

LEFT (DRIVER) SIDE SHOWN
-RIGHT (PASSENGER) SIDE OPPOSITE-

FIG. 1

LOVERNE
A LUYKENS COMPANY
1200 E. Street St. Philadelphia, PA 19106

REVISION B 05MAR12
REVISION A 20JAN11
551884 SHEET 3 OF 3 28SEP10