

INSTALLATION INSTRUCTIONS AND PARTS LIST

APPLICATION: MODEL 481511 STAINLESS STEEL SIDE ENTRY STEPS ON:
2500/3500 SERIES CHEVROLET AND GMC REGULAR CAB PICKUPS



1. READ INSTRUCTIONS COMPLETELY AND CHECK TO MAKE SURE THAT ALL REQUIRED PARTS (LISTED ON SERVICE PARTS LIST) ARE ON HAND BEFORE STARTING THE INSTALLATION.
2. PREASSEMBLE THE FRONT LEFT HAND BRACKETS (ITEMS #12, 14) AS SHOWN IN **FIG. 1** USING (3) 3/8-16 X 1.0 SCREW, 3/8" FLAT WASHERS AND 3/8" FLANGE NUT. (ITEM #18, 19, 21).
NOTE: IF YOU ARE MOUNTING THE STEPS ON A 1500 MODEL PICKUP, YOU MUST ATTACH THE SMALL 90 DEG. BRACKET (ITEM #22) TO THE FRONT BRACKETS (SEE FIG 1). REPEAT FOR FRONT RIGHT HAND BRACKETS (ITEMS #13, 14). TORQUE TO 19 LB. FT.
3. ASSEMBLE THE LOAD REACTION STUDS AND HARDWARE (ITEM #17 THRU #20) AS FOLLOWS.
 - 3.1. ON THE SHORT THREADED END OF THE LOAD REACTION STUD (ITEM #20), INSTALL A 3/8" SERRATED FLANGE NUT (ITEM #19) BACKWARDS TO THE BOTTTOM OF THE THREAD. THEN INSTALL A 3/8" FLAT WASHER (ITEM #18) AND RUBBER "CUSHION" WASHER (ITEM # 17) TIGHT UP AGAINST THE SERRATED FLANGE NUT. (THE END OF THE STUD MUST BE RECESSED IN THE RUBBER WASHER APPROX. 3/16").
 - 3.2. ON THE LONG THREADED END OF THE STUD, INSTALL A 3/8" SERRATED FLANGE NUT (ITEM # 19) BACKWARDS TO NEAR TO THE BOTTTOM OF THE THREADS
4. ATTACH THE LOAD REACTION STUD ASSEMBLIES TO THE MOUNTING BRACKETS AS SHOWN. INSERT THE STUD, FROM WHAT WILL BE IN THE INBOARD OR FRAME SIDE THRU THE LOWEST HOLE IN THE BENT FLANGE OF THE BRACKET THAT WILL ALLOW THE RUBBER WASHER TO SEAT FIRM AGAINST THE SIDE WALL OF THE FRAME. INSTALL A BLACK FLANGE NUT (ITEM #19) ON THE OUTBOARD END OF THE STUD (FINGER TIGHT ONLY).

NOTE:

DUE TO EXCESSIVE THREAD LOCKER IN THE BODY MOUNT BOLT AREA ON THE 2010+ GM SILVERADO/SIERRA, USE CAUTION WHEN REMOVING THE BODY MOUNT BOLTS.

5. REMOVE THE FACTORY FRONT, AND REAR BODY MOUNT BOLTS (ONE SIDE OF THE VEHICLE AT A TIME) AND INSTALL THE MOUNTING BRACKETS PER THE FOLLOWING INSTRUCTIONS:
 - 5.1. INSTALL THE FRONT MOUNTING BRKT (ITEM #14) TO THE FRONT BODY MOUNT AS SHOWN (LEAVE THESE FASTENERS FINGER TIGHT).
 - 5.2. INSTALL THE REAR MOUNTING BRKTS (ITEM #15, 16) & WASHER (ITEM #23) TO THE REAR BODY MOUNT AS SHOWN (LEAVE THESE FASTENERS FINGER TIGHT).
6. ATTACH THE STEP PLATE ASSYS (ITEM #1 THRU #9) TO THE MTG BRKTS. USE #10-24 X 3/4 CARRIAGE BOLT (ITEM #10) & #10-24 SERRATED FLANGE NUT (ITEM #11). (TORQUE THESE FASTENERS TO 6 LB. IN.) **(NOTE: INSURE THAT THE MOUNTING BRACKETS DO NOT TOUCH THE INSIDE WALL OF THE BODY MOUNT HOUSING AND TORQUE THE BODY MOUNT FASTENERS TO MANUFACTURES SPECS) .**
7. POSITION THE STUD ASSY SO THAT THE RUBBER CUSHION IS SNUG UP AGAINST THE SIDE OF THE FRAME. TIGHTEN THE 3/8" FLANGE NUTS ON EITHER SIDE OF THE BRKT TO 19LB. FT.



(A LIVERNE Company)

1200 E. Birch St.

Brandon, SD 57005

551839 SHEET 1 OF 3 25MAR14

SERVICE PARTS LIST

ITEM	PART NO.	QTY	DESCRIPTION
1	551840	1	STEP PLATE -RH, CHEVY/GMC 2500/3500, REGULAR CAB
2	551841	1	STEP PLATE -LH, CHEVY/GMC 2500/3500, REGULAR CAB
3	104250	2	END CAP-RH FRONT/LH REAR
4	104251	2	END CAP-LH FRONT/RH REAR
5	105500	4	PAD-MLD,STEP PLATE,20.00 X 5.50
6	104256	2	TRIM-SEAL,SES,EXTD,60.5", EXT CAB
7	104257	12	NUT-HEX,SGL SELF THD,CAP WASHER,1/4"
8	107645	4	CLIP-U, .115-.185, BLK
9	107958	4	SCR-PPH, #8-18 X 1/2", SST
10	104258	8	BOLT, ROUND HEAD, SST, #10-24 X 3/4"
11	104261	8	NUT, SERR FLG, HEX, SST, #10-24
12	551814	1	BRACKET-MTG, FRONT, LH, 481512/481513
13	551817	1	BRACKET-MTG, FRONT, RH, 481512/481513
14	551817	2	BRACKET-MTG, FRONT, INBOARD, 481512/481513
15	551815	1	BRACKET-MTG, CENTER, LH, 481112/481113
16	551818	1	BRACKET-MTG, CENTER, RH, 481112/481113
17	102592	4	WSHR, RUBBER, .354 ID X 1.00 OD X .75 THK
18	100062	10	WSHR, FL, 3/8", .438 ID X 1.00 OD X .083" THK
19	100181	18	NUT, SERR FLG, HEX, 3/8-16 UNC, ZP
20	104686	4	STUD, -DBL ENDED, STL, 3/8-16 X 4.00", ZP
21	100040	6	SCR-HEX HD, 3/8-16 UNC, ZP
22	551571	2	BRACKET-90 DEGREE, 3 HOLE
23	108882	2	WSHR, FL, .59 ID X 1.06 OD X .19 THK, ZP



(A LIVERNE Company)

1200 E. Birch St.

Brandon, SD 57005

FIG. 2

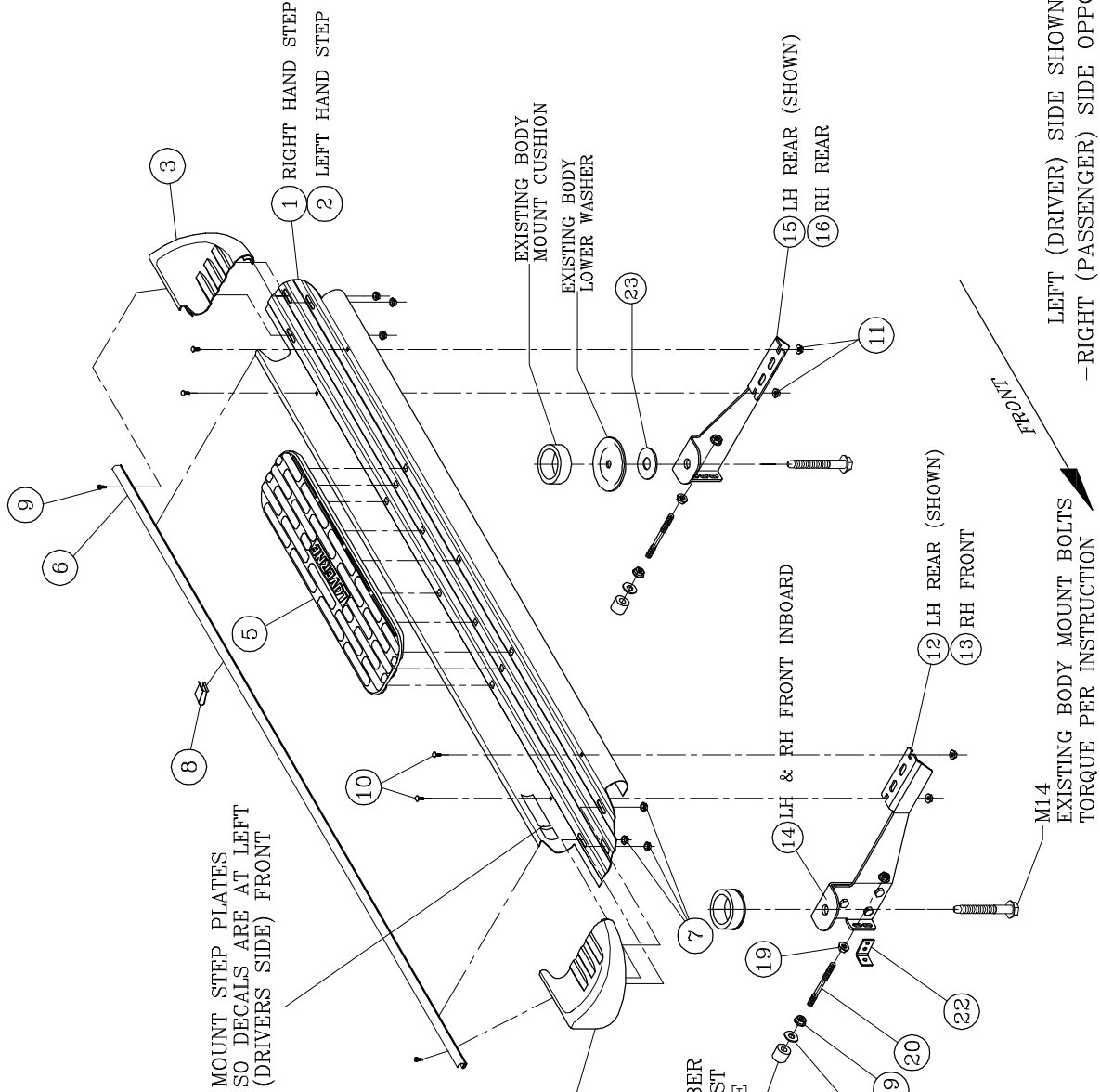

SERVICE PARTS LIST

MODEL NO. -481511

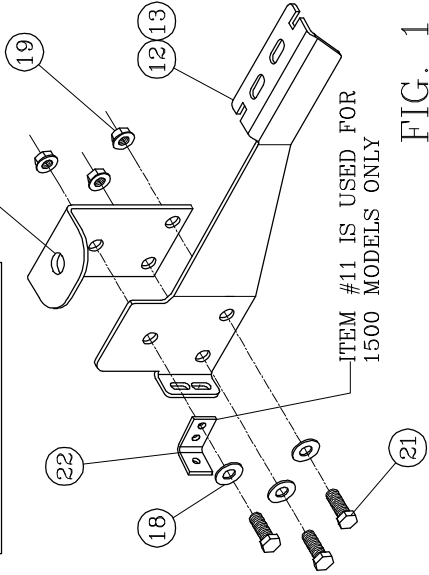

FIG. 1



1200 E. Birch St.
Greenville, SD 57105