

INSTALLATION INSTRUCTIONS AND PARTS LIST

MODEL 570341 MEGA STEPS

VEHICLE APPLICATION:

2003 AND NEWER CUT-A-WAY CHEVROLET EXPRESS AND GMC SAVANA VAN CHASSIS/CABS

READ INSTRUCTIONS COMPLETELY AND CHECK TO MAKE SURE THAT ALL REQUIRED PARTS (LISTED ON SERVICE PARTS LIST) ARE ON HAND BEFORE STARTING THE INSTALLATION

1. ON THE LEFT SIDE OF THE VEHICLE, REMOVE THE FRONT BODY MOUNTING BOLT. THE BOLT, STEEL WASHER AND RUBBER CUSHION WILL BE REUSED.
2. INSTALL THE MULTI-THREAD U-NUT (ITEM #9) ON THE FRONT MOUNTING BRACKET (ITEM #2) AND ASSEMBLE THE 3/8"-16 X 5 STUD (ITEM #6), 3/8"-16 SERRATED FLANGE NUTS (ITEM #8) AND THE .354 X 1.00 X .748 RUBBER WASHER (ITEM #10) INTO THE U-NUT (ITEM #9) (**LOAD REACTION BOLT ASSEMBLY**) AS SHOWN IN *fig. 1*.
3. INSTALL THE FRONT MOUNTING BRACKET TO THE FRONT BODY MOUNT WITH THE WASHER AND THE RUBBER CUSHION BETWEEN THE MOUNTING BRACKET AND THE BODY MOUNT. THE STEP END OF THE BRACKET SHOULD BE PERPENDICULAR TO THE OUTSIDE BODY. TIGHTEN THE BOLT TO 65 LB. FT. ADJUST THE LOAD REACTION BOLT ASSEMBLY SO THAT THE RUBBER CUSHION IS SNUG AGAINST THE FRAME AND TIGHTEN DOWN THE OUTSIDE FLANGE NUT.
4. REMOVE THE SECOND BODY MOUNTING BOLT. THE BOLT, STEEL WASHER AND RUBBER CUSHION WILL BE REUSED.
5. INSTALL THE MULTI-THREAD U-NUT (ITEM #9) ON THE SECOND MOUNTING BRACKET (ITEM #4) AND ASSEMBLE THE 3/8"-16 X 3" STUD (ITEM #7), 3/8"-16 SERRATED FLANGE NUT (ITEM #8) AND THE 5/8" VINYL CAP PLUG (ITEM #11) INTO THE U-NUT (ITEM #9) (**LOAD REACTION BOLT ASSEMBLY**) AS SHOWN IN *fig. 1*.
6. INSTALL THE SECOND MOUNTING BRACKET TO THE SECOND BODY MOUNT WITH THE WASHER AND THE RUBBER CUSHION BETWEEN THE MOUNTING BRACKET AND THE BODY MOUNT. THE STEP END OF THE BRACKET SHOULD BE PERPENDICULAR TO THE OUTSIDE BODY. TIGHTEN THE BOLT TO 65 LB. FT. ADJUST THE LOAD REACTION BOLT ASSEMBLY SO THAT THE END OF THE BOLT IS SNUG AGAINST THE FRAME AND TIGHTEN DOWN THE OUTSIDE FLANGE NUT.
7. INSTALL TWO SQUARE HEAD SCREWS, 5/16"-18 X 1" (ITEM #20) IN THE FRONT TRACK OF THE STEP PLATES.
8. POSITION THE MEGA STEP ON THE MOUNTING BRACKETS SO THAT THE SQUARE HEAD SCREWS ARE LOCATED IN THE SLOTS OF THE MOUNTING BRACKETS AND THE STEP IS CENTERED, FRONT TO REAR, ON THE VEHICLE. INSTALL 5/16" SERRATED FLANGE NUTS (ITEM #21) ON THE SQUARE HEAD SCREWS. FINGER TIGHTEN ONLY AT THIS TIME.
9. ALIGN THE STEP PLATE WITH THE BOTTOM OF THE BODY SHEET METAL. THE TOP OF THE STEP SHOULD BE APPROXAMATELY 2-1/2" FROM THE BOTTOM OF THE BODY PANEL.



(A LIVERNE Company)

1200 E. Birch St.

Brandon, SD 57005

552118 SHEET 1 OF 3 11JUN12

10. TIGHTEN THE STEP PLATE BOLTS TO 19 FOOT POUNDS OF TORQUE.

SERVICE PARTS LIST

ITEM	PART NO.	QTY	DESCRIPTION
1	575036	1	STEP ASSY- 36.00" (MOD. 575036)
2	552100	1	MOUNTING BRACKET – LH, FRONT
3	552101	1	MOUNTING BRACKET – RH, FRONT
4	552115	1	MOUNTING BRACKET – REAR, LH
5	552116	1	MOUNTING BRACKET – REAR, RH
6	104673	2	STUD – DOUBLE END, 3/8"-16 X 5", ZP
7	104697	2	STUD – FULL THREAD, 3/8"-16 X 3", ZP
8	100181	6	NUT – SERRATED FLANGE, 3/8"-16, ZP
9	109258	4	U-NUT – MULTI THREAD, 3/8"-16 X 1.09"
10	102592	2	RUBBER WASHER - .354 X 1.00 X .748
11	103325	2	VINYL CAP PLUG - .364 X 5/8"
12	106880	8	BOLT - SQUARE HEAD, 5/16"-18 X 1", ZP (INCLUDED IN STEP)
13	102680	8	NUT – HEX FLANGE, 5/16"-18 (INCLUDED IN STEP)



SERVICE PARTS LIST

MODEL NO. - 570341

LEFT (DRIVER) SIDE SHOWN
RIGHT (PASSENGER) SIDE OPPOSITE

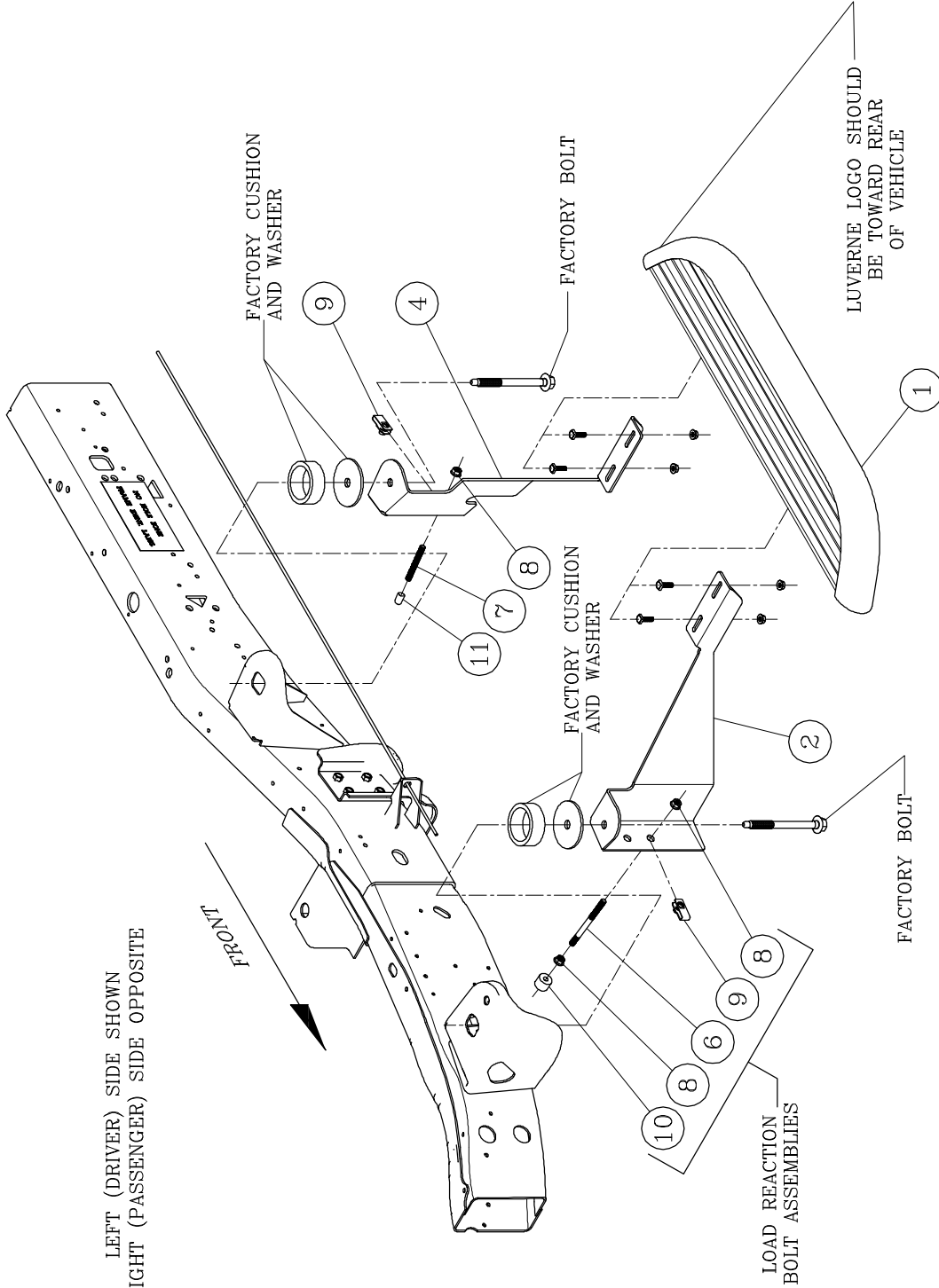

fig. 1



1200 E. Birch St.
Brampton, SD 57005