

INSTALLATION INSTRUCTIONS AND PARTS LIST

APPLICATION: MODEL 200014 & 200014T STAINLESS STEEL SIDE ENTRY STEPS ON:
2000 AND NEWER 1500 SERIES CHEVROLET SUBURBAN AND GMC YUKON XL
2000 AND NEWER CHEVROLET TAHOE AND GMC YUKON



1. READ INSTRUCTIONS COMPLETELY AND CHECK TO MAKE SURE THAT ALL REQUIRED PARTS (LISTED ON SERVICE PARTS LIST) ARE ON HAND BEFORE STARTING THE INSTALLATION.
2. PEEL AWAY THE PROTECTIVE VINYL COVERING AND CLEAN THE TOP OF EACH STEP PLATE TO REMOVE ANY VINYL COVERING RESIDUE. (A GOOD GLASS CLEANER IS SUGGESTED).
3. REMOVE THE FACTORY FRONT, CENTER AND REAR BODY MOUNT BOLTS (ONE SIDE OF THE VEHICLE AT A TIME) AND INSTALL THE MOUNTING BRACKETS AND SIDE ENTRY STEPS PER THE FOLLOWING INSTRUCTIONS.
 - 3.1. INSTALL THE FRONT MOUNTING BRACKETS (ITEM #8 & #9) ON THE FRONT BODY MOUNTS AS SHOWN. REUSE THE EXISTING M12-1.75 X 120mm OR THE M14-2.00 X 120mm FACTORY BOLTS AND ½" FLAT WASHER (ITEM #18). (LEAVE THESE FASTENERS FINGER TIGHT).
 - 3.2. INSTALL THE CENTER MOUNTING BRACKETS (ITEM #10 & #11), REAR MOUNTING BRACKETS (ITEM #12 & #13) & SPACERS (ITEM #14) TO THE CENTER AND REAR BODY MOUNTS AS SHOWN. ON MODEL YEAR 2000 THRU 2005, USE M12 X 1.75 X 130mm (APPROX. 5-1/8") HEX HEAD SCREWS (ITEM #15), 1/2" LOCK WASHERS (ITEM #17) & 1/2" FLAT WASHERS (ITEM #18). ON MODEL YEAR 2006 TO CURRENT, USE M14-2.00 X 130mm HEX HEAD SCREWS (ITEM #16), ½" LOCK WASHERS (ITEM #17) AND ½" FLAT WASHERS (ITEM #18). (LEAVE THESE FASTENERS FINGER TIGHT).
 - 3.3. ATTACH THE STEP PLATE ASSEMBLIES (ITEM #1 THRU #7) TO THE MOUNTING BRACKETS. USE #10-24 X ¾ CARRIAGE BOLTS (ITEM #19), #10 NEOPRENE WASHERS (ITEM #20) & #10-24 SERRATED FLANGE NUTS (ITEM #21). (TORQUE THESE FASTENERS TO 6 LB. IN.) (NOTE: INSURE THAT THE STEP PLATE MOUNTING BRACKETS DO NOT TOUCH THE INSIDE WALL OF THE BODY MOUNT HOUSING AND TORQUE THE BODY MOUNT FASTENERS TO 65 LB. FT.)
 - 3.4. ASSEMBLE THE 4.00" LONG THREADED STUD (ITEM #23) AND FASTENERS TO THE 90 DEGREE MTG BRKT (ITEM #22) AS FOLLOWS.
 - 3.4.1. ON THE SHORT THREADED END OF THE STUD, INSTALL A 3/8" SERR FLG NUT (ITEM #25) BACKWARDS TO THE END OF THE THREAD. THEN, INSTALL A 3/8" FLAT WASHER (ITEM #26) AND RUBBER WASHER (ITEM #24) TIGHT UP AGAINST THE SERR FLG NUT. (THE END OF THE STUD SHOULD BE RECESS BACK IN THE HOLE OF THE RUBBER WASHER APPROXIMATELY 3/16").
 - 3.4.2. ON THE LONG THREADED END OF THE STUD, INSTALL A 3/8" SERR FLG NUT (ITEM #25) BACKWARDS ON THE THREAD SO ABOUT 1.00" OF THREAD IS EXPOSED. INSERT THE STUD THRU THE HOLE IN THE SHORT LEG OF THE MTG BRKT (ITEM #22) (ORIENTATION AS SHOWN) & INSTALL A 3/8" SERR FLG NUT ON THE END OF THE STUD AS SHOWN.
 - 3.4.3. ATTACH THE BRKT/STUD ASSY TO THE STEP PLATE MTG BRKTS, AS SHOWN, USING 3/8" X 1.00" HEX HD SCREW (ITEM #27) WITH 3/8" FLAT WASHER (ITEM #26) & 3/8" SERR FLG NUT (ITEM #25). POSITION THE STUD ASSY SO THAT THE RUBBER CUSHION IS SNUG UP AGAINST THE SIDE OF THE FRAME. TIGHTEN THE 3/8" FLG NUTS ON EITHER SIDE OF THE BRKT TO LOCK THE STUD ASSY IN POSITION.

LIVERNE
ISO9001 QS9000 CERTIFIED TRUCK
EQUIPMENT
1200 Birch Street
Brandon, SD 57005 INC.

REVISED 29 AUG 05 LEV C
REVISED 27 JAN 03 LVL B
REVISED 10APR00 LVL A
549496 SHEET 1 08DEC99

SERVICE PARTS LIST

ITEM	PART NO.	QTY	DESCRIPTION
1	549484	1	STEP PLATE-RH,SUBURBAN/YUKON XL
2	549485	1	STEP PLATE-LH,SUBURBAN/YUKON XL
1	549501	1	STEP PLATE-RH,TAHOE/YUKON
2	549502	1	STEP PLATE-LH,TAHOE/YUKON
3	104250	2	END CAP-RH FRONT/LH REAR
4	104251	2	END CAP-LH FRONT/RH REAR
5	105500	4	PAD-MLD,STEP PLATE,20.00 X 5.50
6	102502	2	TRIM-SEAL,SES,EXTD,95" LG,SUB/YUKON XL
6	104255	2	TRIM-SEAL,SES,EXTD,80.5" LG,TAHOE/YUKON
7	104257	12	NUT-HEX,SGL SELF THD,CAP WASHER,1/4"
8	549488	1	BRACKET-MTG,FRONT,RH,200014 / 200014T
9	549489	1	BRACKET-MTG,FRONT,LH,200014 / 200014T
10	549490	1	BRACKET-MTG,CENTER,RH,200014 / 200014T
11	549491	1	BRACKET-MTG,CENTER,LH,200014 / 200014T
12	549492	1	BRACKET-MTG,REAR,RH,200014 / 200014T
13	549493	1	BRACKET-MTG,REAR,LH,200014 / 200014T
14	549495	4	SPACER-MTG BRKT,200014 SERIES
15	103442	4	SCREW-HEX HD CAP,M12-1.75 X 130mm,10.9,ZP
16	107199	4	SCREW-HEX HD CAP,M14-2.00 X 130mm10.9,ZP
17	100121	4	WASHER-LOCK,HS,REG,1/2",ZP
18	100118	6	WASHER-PL,A,STL,1/2",ZP
19	104258	12	BOLT-CARRIAGE,SST,#10-24 X 3/4"LG
20	104530	12	WASHER-FLAT,NEOPRENE,#10
21	104261	12	NUT-SERRATED FLANGE,HEX,SST,#10-24
22	601647	4	BRACKET-MTG,STL,90 DEG, .406 DIA HOLES,ZP
23	104686	4	STUD-DOUBLE ENDED,STL,3/8-16 UNC X 4.00",ZP
24	102592	4	WASHER-RUBBER,.354 ID X 1.00 OD X .75 THK
25	100181	16	NUT-SERRATED FLANGE,HEX,3/8-16 UNC,ZP
26	100062	8	WASHER-PL,A,STL,3/8",ZP
27	100040	4	SCREW-HEX HD CAP,3/8-16 UNC X1"LG

LIVERNE
ISO9001/ISO9000 CERTIFIED TRUCK
 1200 Birch Street EQUIPMENT
 Brandon, SD 57005 INC

REVISED 29 AUG 05 LVL C
 REVISED 27 JAN 03 LVL B
 REVISED 10 APR 00 LVL A
 549496 SHEET 2 08DEC99

SERVICE PARTS LIST

MODEL NO. - 200014
 MODEL NO. - 200014T

MOUNT STEP PLATES
 SO DECALS ARE AT LEFT
 (DRIVERS SIDE) FRONT

LOCATE RUBBER
 WASHER AGAINST
 SIDE OF FRAME

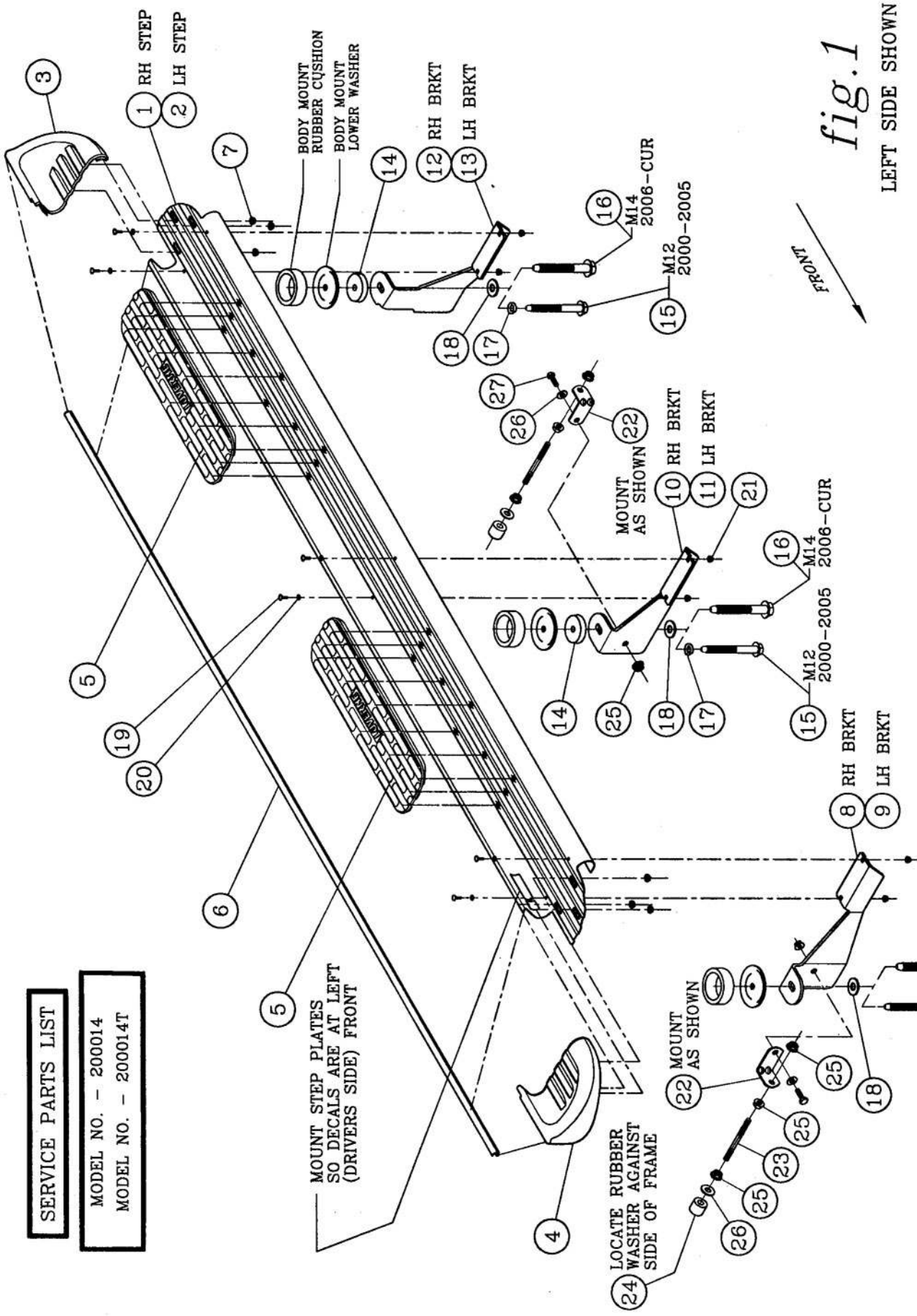

fig.1

LEFT SIDE SHOWN

M14 2006-CUR
 EXISTING BODY MOUNT BOLT
 TORQUE PER INSTRUCTION

M12
 2000-2005

LIVERNE
 TRUCK
 EQUIPMENT
 INC.
 1200 Birch Street
 Brandon, SD 57005

REVISED 29AUG05 LVL C
 REVISED 27JAN03 LVL B
 REVISED 10APR00 LVL A
 549496 SHEET 3 08DEC99